

Vacation rental Les Deux Alpes "L'OLYMPE"

2 Alpes, apartment 4/6 people, on foot of the ski tracks, Internet WIFI free.



Apartment-Flat 3rd floor, shared entrance, in(on) a(an) Estate 4 floors

Setting : ski to door, pleasant

Capacity : 6 person(s)

Bedroom(s) : 1

Room(s) : 2



Clé vacances (3 keys)

Les Deux Alpes - Isère (38) - Rhône Alpes

France

Reservation : +33 (0) 6 18 42 60 56 (France)

Advert No. 28300

www.ph.ih.com



Vacation rental



Apartment-Flat 3rd floor, shared entrance, in(on) a(an) Estate 4 floors

- View : unobscured, not overlooked, mountain, street/avenue
- Setting : ski to door, pleasant
- Exposure : West

"Apartment equipped with a bedroom with 1 bed for 2 people and cupboards, a living room with 2 bunk beds, 1 click clas for 2 people. Flat screen TV, DVD player. A kitchen equipped with a dishwasher, a refrigerator, induction 3 lights, traditional oven, a microwave, a coffee maker, a kettle. Bathroom toilet."

Assets

- Parking :
Parking uncovered : 1 internal.
- Advantages :
Ski locker



living room

Surroundings & location



Mountain



Ski

"75 km from Grenoble by road. Bus stop from Grenoble at the foot of the building. 75 lifts. Many summer activities. Opening season November 29 until April 25."

Leisure

- Leisure activities less than 12 miles :
Alpine skiing, ski-trekking, snowboarding, luge (run), skidoo, bathing, canoeing, rafting, golf, tennis, riding school, hiking, paragliding, horse trekking, mini-golf, ten-pin bowling, fishing
- Supervised :
Ski school, kids ski area
- Attractions and relaxation :
Bar/pub, discotheque, restaurant, movie theater, health spa

Surroundings

- Locality :
Ski slopes <50m
Ski lifts 100m
Ice skating rink 500m
- Amenities :
Bus stop / bus station 50m
Local stores 50m
Supermarket 300m



separate kitchen



living room



master bedroom

Interior

- **Receive up to :**
6 person(s) (4 adults, 2 kids)
- **Liveable floor area :**
38m²
- **Interior layout :**
2 Room(s), 1 bedroom(s), 1 shower room, living room 20m², sitting room 10m², separate kitchen
- **Sleeps - bed(s) :**
1 full bed(s), 1 sleeper sofa(s) 2 pers, 1 bunk beds
- **Guest facilities :**
Elevator, T.V., DVD player, t.v points, internet access, wifi, cupboard, Hanging wardrobe, hair dryer, central heating, electric heating, Glazed in area, Drapes, electric shutters, remote controlled gates
- **Appliances :**
Crockery/flatware, kitchen utensils, cafetiere, electric coffee maker, toaster, juicer, food processor, pancake maker, electric raclette set, electric hobs, oven, micro-wave oven, extractor hood, refridgerator, dish washer, vacuum cleaner, iron, ironing board

Exterior

- **Outside accommodation :**
Balcony 11m²



view from the apartment

Services

- **Single family home :**
Caretaker/concierge, Parking

For your guidance

- **For your guidance**
Pets accepted under certain conditions (ask the owner)
Cell phone network coverage, personal transport advisable
Water : hot/cold
Local voltage supply : 110-120V / 60Hz
Electricity supply : mains



shower room

Floor plan

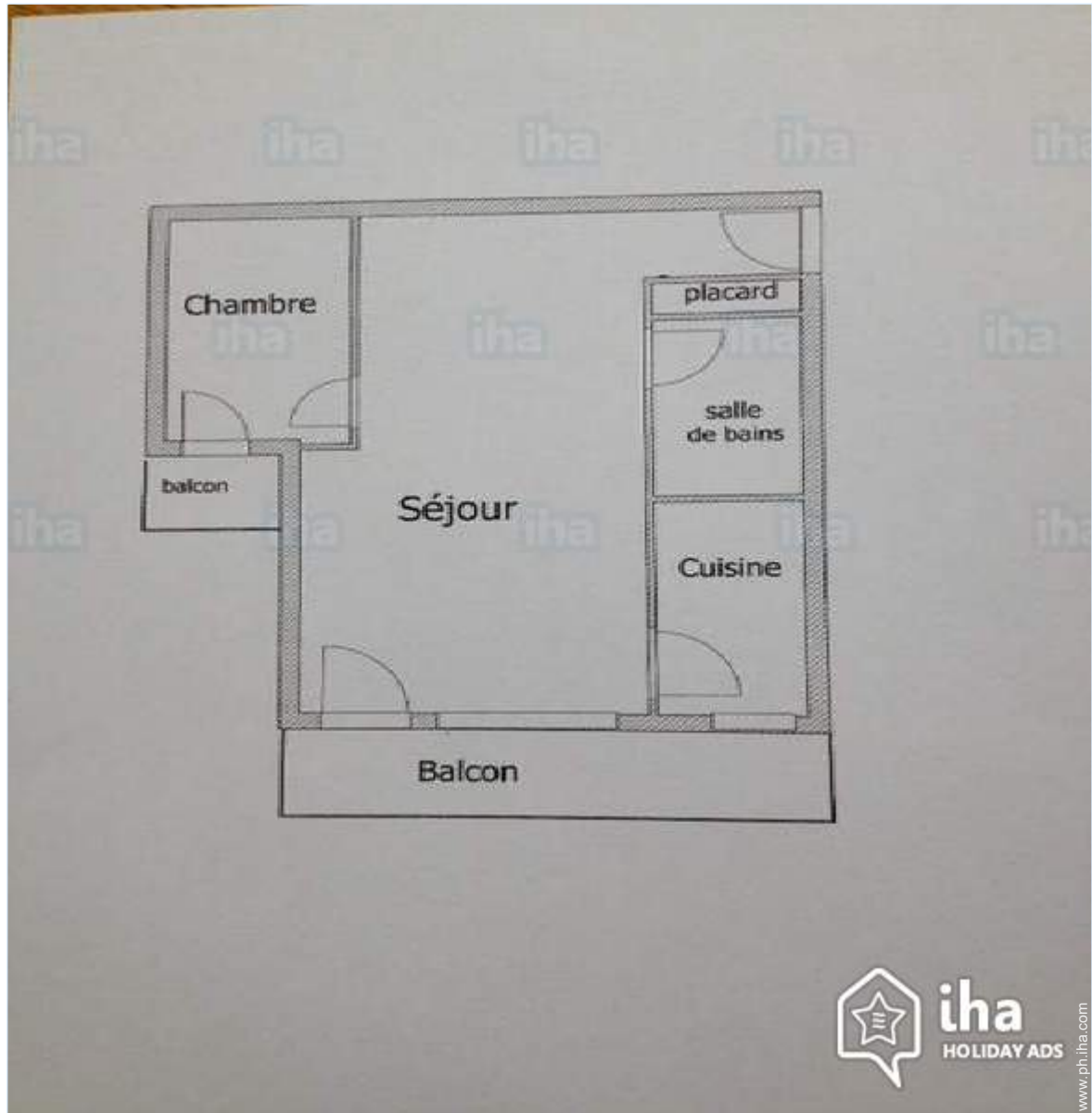

Photo album - 1



living room



living room



separate kitchen

Photo album - 2



master bedroom



shower room



view from the apartment



view from the apartment



the apartment house/building

Location

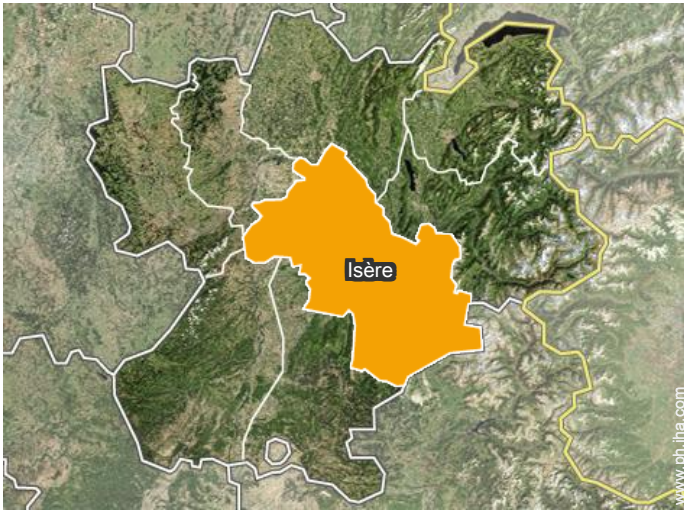

Vacation rental Les Deux Alpes - France "L'OLYMPE"

9

[Book now](#)

Availability calendar - from : october 2018

Oct	M	Tu	W	Th	F	Sa	Su	M	Tu	W	Th	F	Sa	Su	M	Tu	W	Th	F	Sa	Su	M	Tu	W							
2018	1	2	3	4	5	6	7	8	9	10	11	12	13	14	15	16	17	18	19	20	21	22	23	24	25	26	27	28	29	30	31

Nov	Th	F	Sa	Su	M	Tu	W	Th	F	Sa	Su	M	Tu	W	Th	F	Sa	Su	M	Tu	W	Th	F							
2018	1	2	3	4	5	6	7	8	9	10	11	12	13	14	15	16	17	18	19	20	21	22	23	24	25	26	27	28	29	30
	-	-	-	-	-	-	-	-	-	-	-	-	-	-	-	-	-	-	-	-	-	-	-	-	-	-	-	-	-	-

Dec	Sa	Su	M	Tu	W	Th	F	Sa	Su	M	Tu	W	Th	F	Sa	Su	M	Tu	W	Th	F	Sa	Su	M							
2018	1	2	3	4	5	6	7	8	9	10	11	12	13	14	15	16	17	18	19	20	21	22	23	24	25	26	27	28	29	30	31
	-	-	-	-	-	-	-	-	-	-	-	-	-	-	-	-	-	-	-	-	-	-	-	-	-	-	-	-	-	-	

Jan	Tu	W	Th	F	Sa	Su	M	Tu	W	Th	F	Sa	Su	M	Tu	W	Th	F	Sa	Su	M	Tu	W	Th							
2019	1	2	3	4	5	6	7	8	9	10	11	12	13	14	15	16	17	18	19	20	21	22	23	24	25	26	27	28	29	30	31
	-	-	-	-	-	-	-	-	-	-	-	-	-	-	-	-	-	-	-	-	-	-	-	-	-	-	-	-	-	-	

Feb	F	Sa	Su	M	Tu	W	Th	F	Sa	Su	M	Tu	W	Th	F	Sa	Su	M	Tu	W	Th								
2019	1	2	3	4	5	6	7	8	9	10	11	12	13	14	15	16	17	18	19	20	21	22	23	24	25	26	27	28	
	-	-	-	-	-	-	-	-	-	-	-	-	-	-	-	-	-	-	-	-	-	-	-	-	-	-	-	-	-

Mar	F	Sa	Su	M	Tu	W	Th	F	Sa	Su	M	Tu	W	Th	F	Sa	Su	M	Tu	W	Th	F	Sa	Su							
2019	1	2	3	4	5	6	7	8	9	10	11	12	13	14	15	16	17	18	19	20	21	22	23	24	25	26	27	28	29	30	31
	-	-	-	-	-	-	-	-	-	-	-	-	-	-	-	-	-	-	-	-	-	-	-	-	-	-	-	-	-	-	

Apr	M	Tu	W	Th	F	Sa	Su	M	Tu	W	Th	F	Sa	Su	M	Tu	W	Th	F	Sa	Su	M	Tu							
2019	1	2	3	4	5	6	7	8	9	10	11	12	13	14	15	16	17	18	19	20	21	22	23	24	25	26	27	28	29	30
	-	-	-	-	-	-	-	-	-	-	-	-	-	-	-	-	-	-	-	-	-	-	-	-	-	-	-	-	-	-

May	W	Th	F	Sa	Su	M	Tu	W	Th	F	Sa	Su	M	Tu	W	Th	F	Sa	Su	M	Tu	W	Th	F							
2019	1	2	3	4	5	6	7	8	9	10	11	12	13	14	15	16	17	18	19	20	21	22	23	24	25	26	27	28	29	30	31
	-	-	-	-	-	-	-	-	-	-	-	-	-	-	-	-	-	-	-	-	-	-	-	-	-	-	-	-	-	-	

June	Sa	Su	M	Tu	W	Th	F	Sa	Su	M	Tu	W	Th	F	Sa	Su	M	Tu	W	Th	F	Sa	Su							
2019	1	2	3	4	5	6	7	8	9	10	11	12	13	14	15	16	17	18	19	20	21	22	23	24	25	26	27	28	29	30
	-	-	-	-	-	-	-	-	-	-	-	-	-	-	-	-	-	-	-	-	-	-	-	-	-	-	-	-	-	-

Jul	M	Tu	W	Th	F	Sa	Su	M	Tu	W	Th	F	Sa	Su	M	Tu	W	Th	F	Sa	Su	M	Tu	W							
2019	1	2	3	4	5	6	7	8	9	10	11	12	13	14	15	16	17	18	19	20	21	22	23	24	25	26	27	28	29	30	31
	-	-	-	-	-	-	-	-	-	-	-	-	-	-	-	-	-	-	-	-	-	-	-	-	-	-	-	-	-	-	

Mid season

Vacation rental
Rhône Alpes - Les Deux Alpes
"L'OLYMPE"

10
[Book now](#)

Availability calendar - from : july 2019

Aug	Th	F	Sa	Su	M	Tu	W	Th	F	Sa	Su	M	Tu	W	Th	F	Sa	Su	M	Tu	W	Th	F	Sa	Su	M	Tu	W	Th	F	Sa
2019	1	2	3	4	5	6	7	8	9	10	11	12	13	14	15	16	17	18	19	20	21	22	23	24	25	26	27	28	29	30	31
-	-	-	-	-	-	-	-	-	-	-	-	-	-	-	-	-	-	-	-	-	-	-	-	-	-	-	-	-	-	-	-

Sep	Su	M	Tu	W	Th	F	Sa	Su	M	Tu	W	Th	F	Sa	Su	M	Tu	W	Th	F	Sa	Su	M							
2019	1	2	3	4	5	6	7	8	9	10	11	12	13	14	15	16	17	18	19	20	21	22	23	24	25	26	27	28	29	30
-	-	-	-	-	-	-	-	-	-	-	-	-	-	-	-	-	-	-	-	-	-	-	-	-	-	-	-	-	-	-

Mid season

[Month : Next >>](#)

Rental rates - Apartment-Flat - 6 Person(s)

Rates	Night	Weekend	week	2 weeks	Month
<input type="checkbox"/> Low season	-	-	PHP16115* (Saturday)	-	-
<input type="checkbox"/> Mid season	-	-	PHP23552* (Saturday)	PHP27891*	-
<input type="checkbox"/> High season	-	-	PHP51443* (Saturday)	-	-
<input type="checkbox"/> Festive specials	-	-	PHP52683* (Saturday)	-	-
<input type="checkbox"/> Promotional period	-	-	PHP28511* (Saturday)	-	-

(Check-in day)

[Book now](#)



separate kitchen



master bedroom



shower room



living room



living room



Booking conditions

• Reservation

- Payment made upon reservation : 30% of rental sum
- Payment balance : on handing over the keys
- Deposit required : PHP18594*

• rentals

- Service charges included
- Day tax included

Accepted methods of payment

- Check

▶ [Book now](#)

▶ [Contact the owner](#)

Contact directly the property owners

www.ph.ihh.com

Advert No.

28300

>> [Book now](#) <<

Contact

Spoken languages



* Converted at the rate indicated : €100 = \$116.85 = £89 = PHP6197.99

Advert No. 28300

www.ph.ihh.com

